

SC-KD5

**5 METERS
HOT DIP**

GALVANIZED CAMERA POLE



Technical Specifications

| | |
|---------------------|---|
| Lower Body Diameter | : 114 mm |
| Lower Body Length | : 2 m |
| Upper Body Diameter | : 89 mm |
| Upper Body Length | : 3 m |
| Body Thickness | : 3 mm |
| Wind Durability | : 100 km/h |
| Base Plate | : 10 mm x 240 mm x 240 mm |
| Pole foundation | : 4 x M16 Anchor - Anchor Vertical Height : 440mm - Anchor Total Length : 500mm |

Plate Standart

EN10025

Production
Standart

EN40-5

Galvanising
Standart

TSE EN 1461

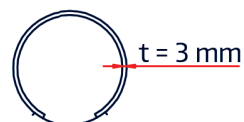
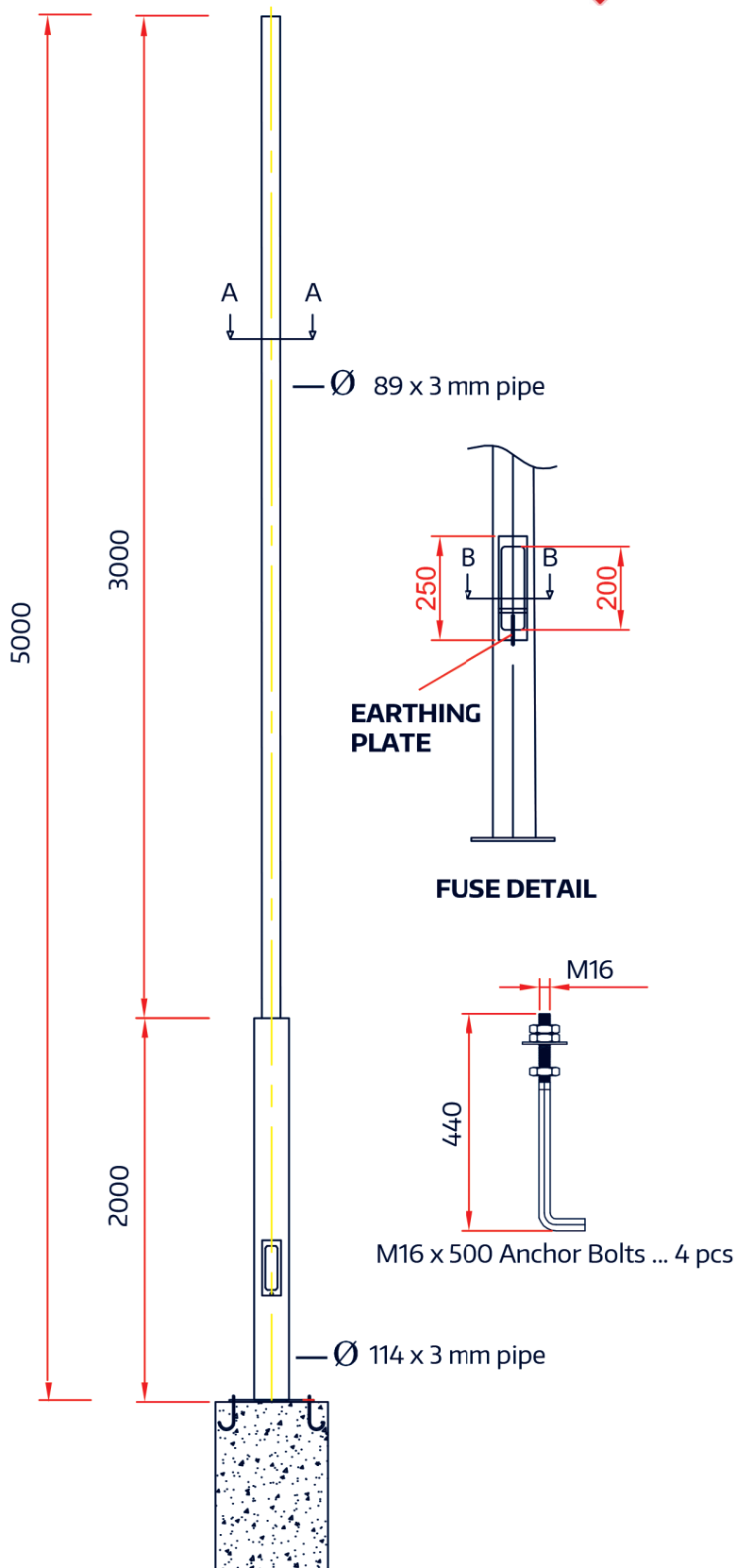

A - A Section

EARTHING PLATE

FUSE RAIL

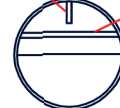

B - B Section



EARTHING PLATE

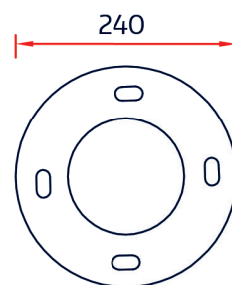

BASE PLATE

10 mm x 240 x 240